



**MATERIAL**

Glass-fibre reinforced polyamide based (PA) technopolymer, chrome-plated, glossy finish.

**STANDARD EXECUTION**

Brass boss, tapped blind hole.

**FEATURES AND APPLICATIONS**

The exclusive five-lobe shape (ELESA original design) offers the operator's fingers a proper grip and prevents unhealthy residues from depositing thanks to its solid shape without cavities.

**CHEMICAL AGENTS RESISTANCE**

This knob is particularly suitable for applications on machines and equipment whose parts, for hygienic reasons, must be frequently cleaned by using water jets or steam.

The chrome-plating makes the surface finish semi-glossy and homogeneous to facilitate cleaning operations.

The chrome-plated surface is resistant to wear, scrapes and shocks. In laboratory tests carried out at ambient temperature (23°C), the chrome-plated surface revealed to be resistant to: sea water, detergents, acetone, ethyl alcohol, formic acid, chlorine solutions.



ELESA Original design

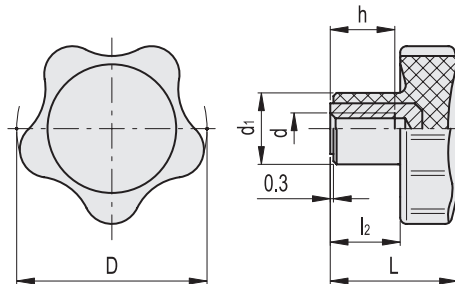

Conversion Table 1 mm = 0.039 inch	
D	
mm	inch
32	1.26
40	1.57
50	1.97
60	2.36

**METRIC**

Code	Description	D	d <sub>H</sub>	L	d <sub>1</sub>	l <sub>2</sub>	h	△
152702	VC.692/32-CR-B-M6	32	M6	22.5	14	12.5	10	14
152712	VC.692/40-CR-B-M8	40	M8	26	15	14	13	23
152722	VC.692/50-CR-B-M10	50	M10	31	18	17	17	40
152731	VC.692/60-CR-B-M10	60	M10	36.5	21	21	20	63